

***CUSTOM
VANITY DESIGN
PROGRAM***

*Exceptional
Cabinetry Made
Affordable!*

1 CHOOSE A VANITY CABINET DOOR STYLE:

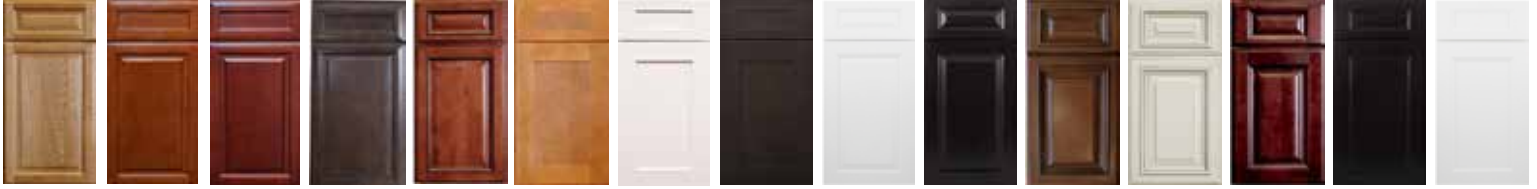

- | | | | | | | | | | | | | | | |
|------------------------------------|-----------------------------|---------------------------|--------------------------|--------------------------|-------------------------|-------------------------------|---------------------------|-----------------------------|--------------------------------|-----------------------------------|------------------------------|-----------------------|----------------------------|---------------------------|
| CYOF
Country Oak Classic | KM
Cinnamon Glaze | KC
Cherry Glaze | KE
K. Espresso | MR
Sienna Rope | AK
Shakertown | AW
Ice White Shaker | AP
Paper Shaker | GW
Gramercy White | GM
Gramercy Midnight | SB
Signature Brownstone | SL
Signature Pearl | PC
Pacifica | TD
Downtown Dark | TW
Uptown White |
|------------------------------------|-----------------------------|---------------------------|--------------------------|--------------------------|-------------------------|-------------------------------|---------------------------|-----------------------------|--------------------------------|-----------------------------------|------------------------------|-----------------------|----------------------------|---------------------------|

2 SELECT VANITY CABINETS YOU NEED: - 21" D x 34 1/2" H

DRAWERS BANKS

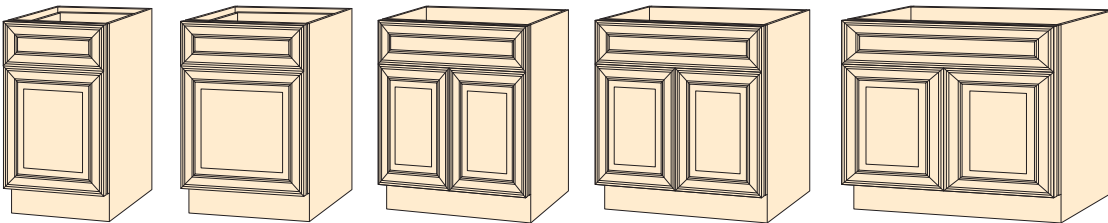

- | | | | | |
|--------------------------------|--------------------------------|--------------------------------|--------------------------------|--------------------------------|
| 18" WIDE
Vanity Base | 21" WIDE
Vanity Base | 24" WIDE
Vanity Base | 30" WIDE
Vanity Base | 36" WIDE
Vanity Base |
|--------------------------------|--------------------------------|--------------------------------|--------------------------------|--------------------------------|

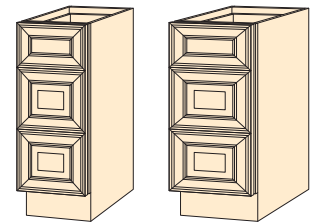

- | | |
|--------------------------------|--------------------------------|
| 12" WIDE
Vanity Base | 15" WIDE
Vanity Base |
|--------------------------------|--------------------------------|

FIXED SIZE VANITY CABINET BASES: - 21" D x 34 1/2" H with 12" W Drawers

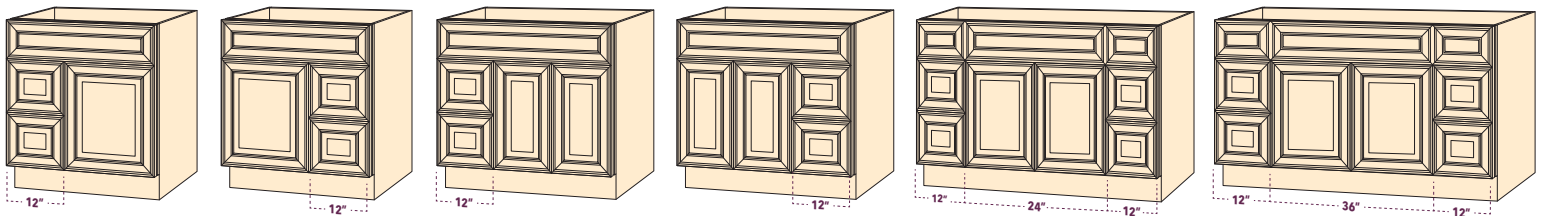

- | | | | | | |
|-----------------------------------|------------------------------------|-----------------------------------|------------------------------------|--|--|
| 30" WIDE
Drawers - Left | 30" WIDE
Drawers - Right | 36" WIDE
Drawers - Left | 36" WIDE
Drawers - Right | 48" WIDE
Drawers - Left, Right | 60" WIDE
Drawers - Left, Right |
|-----------------------------------|------------------------------------|-----------------------------------|------------------------------------|--|--|

COUNTER HUTCH:

LINEN CABINETS & DOUBLE DOOR:

DRAWERS:

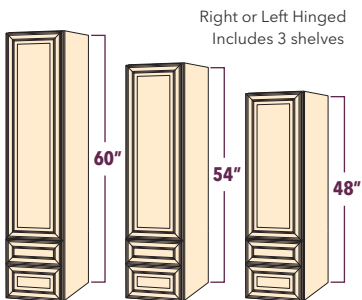

Right or Left Hinged
Includes 3 shelves

18" W X 12" D WITH 2 DRAWERS

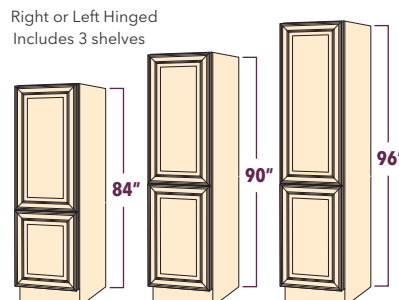

Right or Left Hinged
Includes 3 shelves

18" W X 21" D WITH SHELVES

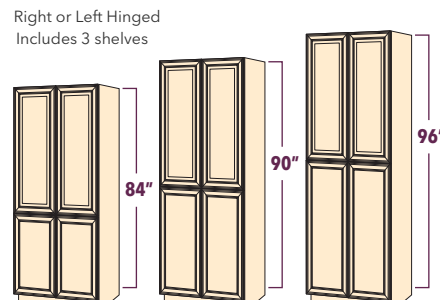

Right or Left Hinged
Includes 3 shelves

24" W X 21" D WITH SHELVES



30" VANITY DRESSING DRAWER

Right or Left Hinged
Includes 3 shelves

30" W X 21" D X 3" H

SPECIAL VANITY ORDER PROGRAM

DELIVERED TO YOUR KNB STORE IN 5 DAYS

3 CHOOSE VANITY CABINET ACCESSORY OPTIONS:

VANITY CABINET FILLERS (can be used between cabinets, against walls, or as a decorative accent)

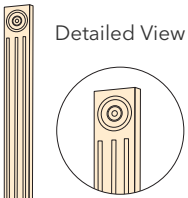

Detailed View

FLUTE FILLER
3"W x 34 1/2"H

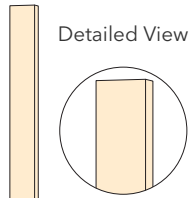

Detailed View

STANDARD FILLER
3"W x 34 1/2"H

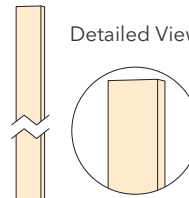

Detailed View

LINEN TALL FILLER
3"W x 96"H

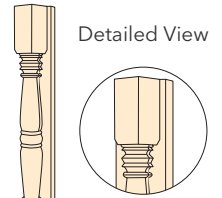

Detailed View

LEG FILLER
3"W x 34 1/2"H

TOE KICKS

Add to Vanity Base for a customized furniture look

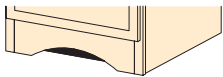

VALANCE TOE KICK
48"W X 4.5"H

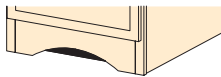

VALANCE TOE KICK
54"W X 4.5"H

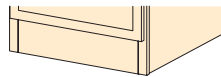

STANDARD TOE KICK
96"W X 4 1/2"H

ACCESSORIES (Crown Molding and Laundry Hamper Kit)



HUTCH CROWN MOLDING
96" X 2 1/4"

(Order for use with hutch and linen cabinets)



LINEN CROWN MOLDING
96" X 2 1/4"

(Order for use with hutch and linen cabinets)



VANITY SCRIBE MOLDING
96" X 3/4"

(Use to fill in small gaps where cabinets meet the wall)

SELECT YOUR DECORATIVE WALL OPTIONS *Crown Molding Included Includes Two Shelves

BATH STORAGE

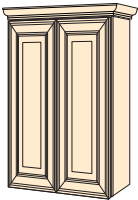

24" WIDE
9"D X 30"H*

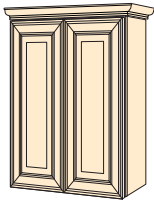

27" WIDE
9"D X 30"H*

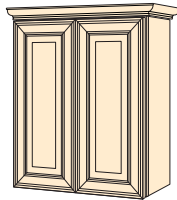

30" WIDE
9"D X 30"H*

WALL HUTCH STORAGE

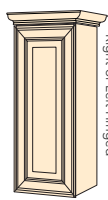

15" WIDE
9"D X 30"H*

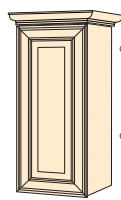

18" WIDE
9"D X 30"H*

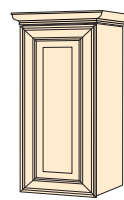

21" WIDE
9"D X 30"H*

FLUTE MIRROR WITH FILLERS

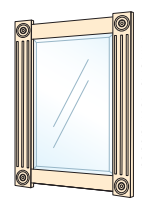

FLUTE MIRROR
24" TO 60" WIDE

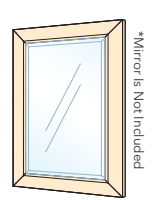

FLAT MIRROR
24" TO 60" WIDE

4 DESIGN & FINISHING TIPS

PLANNING THE SPACE

Ensure your bathroom is properly measured and reviewed prior to finalizing your cabinet order. When designing your bathroom, consider room size and elements such as windows, doors, toilet location, plumbing, electrical outlets and door clearances, as they will influence your layout and cabinet selections.

ACCESSORIES

Crown Molding, Vanity Dressing Drawers, Linen Cabinets, Hutches and Laundry Hamper Kits, add detail to enhance the appearance and maximize storage for your bathroom.

TOE KICKS AND FILLERS

Toe Kicks provide an elegant furniture look to your bathroom cabinets and are offered in all finishes and styles. When designing your layout, Fillers can be added to balance out your available area and fill space.

CABINET LAYOUT

When cabinets are placed next to walls, a filler must be used to separate the cabinets from the wall to prevent the doors and drawers from rubbing.

SINK LOCATION

Keep in mind that sinks can only be placed on Vanity Bases, and not Drawer Banks. Sinks cannot be placed on 18" wide Vanity base.

Use this scaled working grid to design your bathroom plan. A sample diagram is shown below for reference. A store associate can assist with your selection and ordering process.

NOTES:

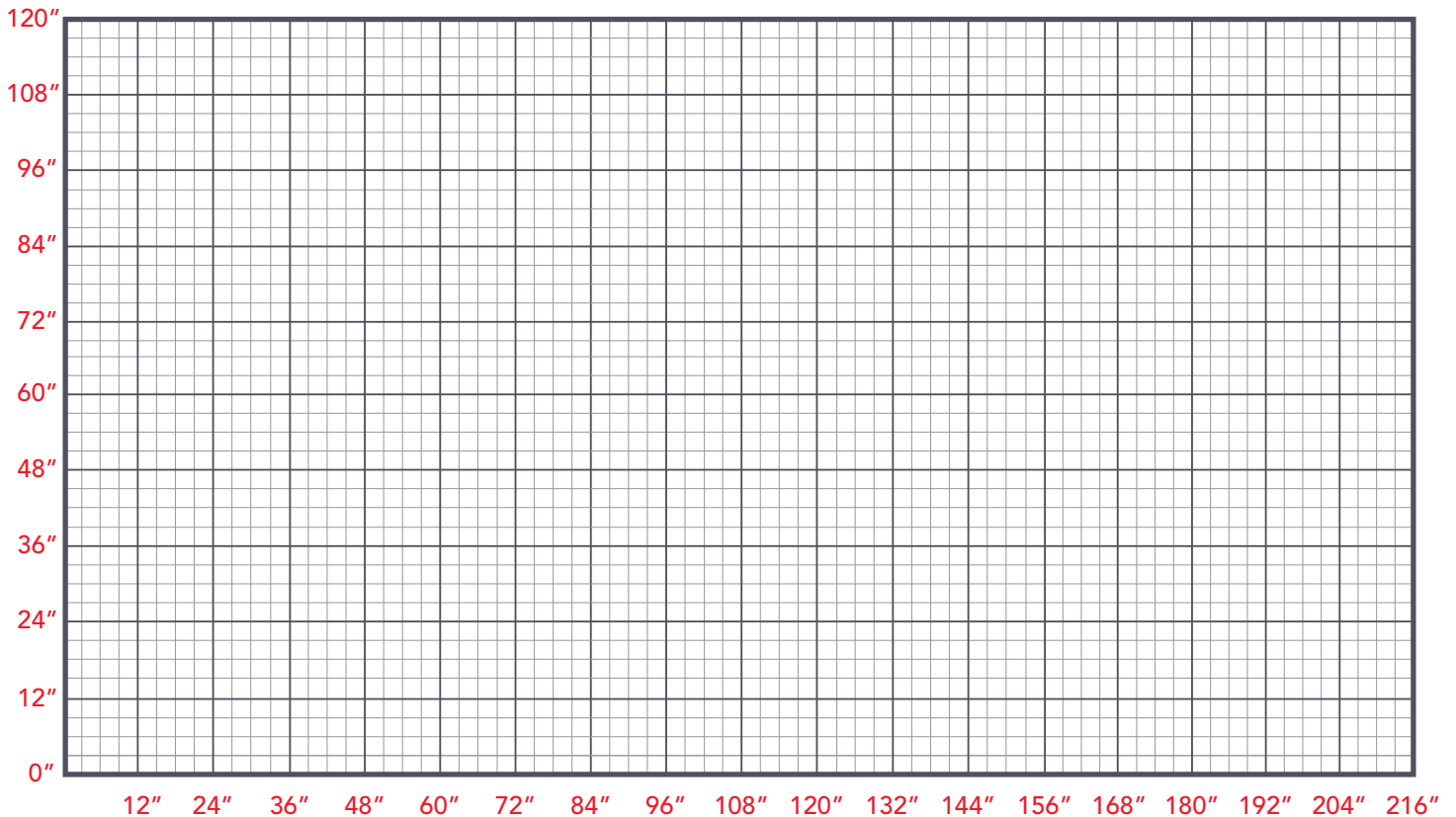
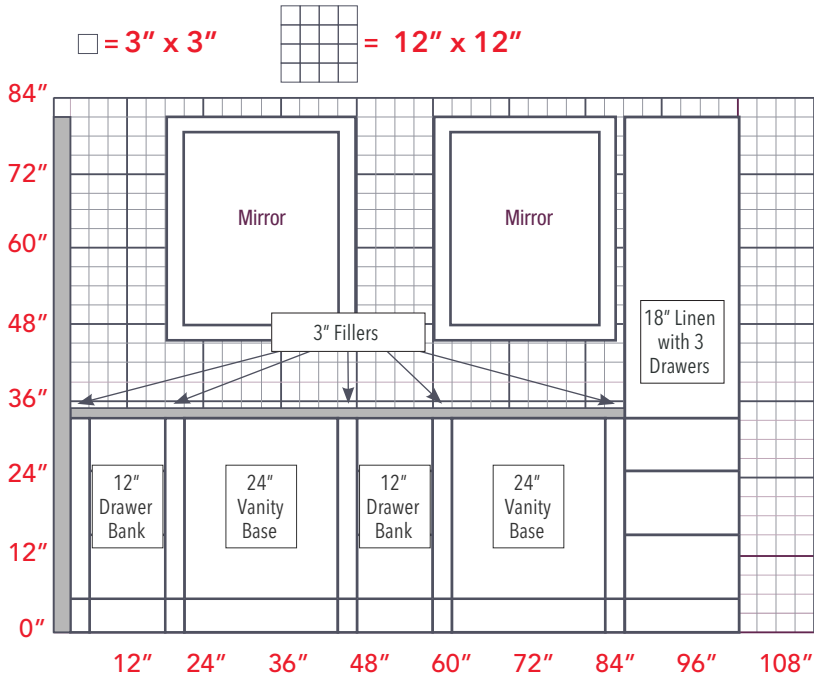

Welcome to kitchenandbathshop.com, the one-stop-shop for stylish and affordable kitchen and bathroom products

We are committed to giving our customers a wide range of modern, traditional and classic kitchens and bathroom options and making the process of finding and buying your dream kitchen and bathroom as easy as possible.

ALEXANDRIA Office: 703.552.2454 5601 General Washington Dr. Unit#H Alexandria, VA 22312 alexandria@kitchenandbathshop.com	CHANTILLY Office: 703.552.2515 4008 Walney Road Unit#C Chantilly, VA 20151 chantilly@kitchenandbathshop.com
FAIRFAX Office: 703.651.1527 3204 Old Pickett Rd, Unit#1A Fairfax, VA 22031 fairfax@kitchenandbathshop.com	FREDERICKSBURG Office: 540.469.4959 4226 Plank Road Fredericksburg, VA 22407 fredericksburg@kitchenandbathshop.com
LEESBURG Office: 703.544.2557 201 Crescent Station Ter. SE Leesburg, VA 20175 leesburg@kitchenandbathshop.com	LORTON Office: 703.544.2426 7000 Newington Road, Suite#J Lorton, VA 22079 lorton@kitchenandbathshop.com
ROCKVILLE Office: 301.416.5424 1055 Rockville Pike, Rockville, MD 20852 rockville@kitchenandbathshop.com	WASHINGTON DC Office: 202.552.6681 3170 Bladensburg Road Washington, DC dc@kitchenandbathshop.com

CALL TO ORDER ON

